

Lenovo
ThinkPad

Lenovo ThinkPad P16 Gen 3
Redefine Mobile Power

Lenovo



intel
vPRO

That's the power of Intel Inside®

Unleash your potential with the Lenovo ThinkPad P16, a mobile powerhouse engineered to take on the heaviest workloads. Now featuring a new chassis design, this device provides enhanced portability while maintaining an elite level of performance. Featuring the latest Intel® Core™ Ultra processors (Series 2) with Intel vPro® technology and accelerated by the NVIDIA RTX PRO™ 5000 Blackwell Generation Laptop GPU (24GB) in a discrete design, the ThinkPad P16 ensures smooth and efficient workflows for even the most demanding applications. Whether you're developing and testing AI models, editing high-resolution videos, or running intensive simulations, this workstation delivers superior, desktop-level power in a mobile form factor.

Processor:

**5.5GHz
24 Cores**

Intel Core Ultra
Processors (Series 2)

Graphics:

**RTX PRO 5000
Blackwell**

High-performance professional
graphics and AI acceleration

Memory:

**192GB
DDR5**

4x SoDIMMs
ECC or non-ECC

AI:

**1860
TOPS**

CPU Package: up to 36 TOPS
GPU: up to 1824 TOPS
Total: up to 1860 TOPS

Features



Desktop Power, Wherever You Go

Up to 24 cores in a new, thinner, and lighter chassis design.

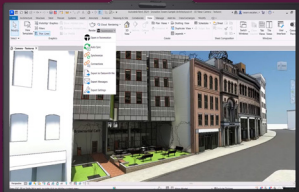

16" 16:10 Display

Three high quality options to suit your budget including new Tandem OLED panel for vibrant visuals and exceptional clarity.



Mobile Power for AI Development

With up to 1860 TOPS, accomplish compute-intensive data science and AI tasks from anywhere—explore large datasets and features, develop, fine-tune, and validate models directly on your laptop.



Reliable Wireless Connectivity

Intel Wi-Fi 7 (5 Gig) delivers enhanced bandwidth and reduced latency for seamless streaming, gaming, and productivity.

Lenovo ThinkPad P16 Gen 3 Product Specifications[^]

Performance

Processor

Intel Core Ultra Processors (Series 2)
HX-Series (up to 24 cores, up to 5.5GHz)^{*}

Graphics

Discrete

Up to NVIDIA RTX PRO 5000 Blackwell
Generation Laptop GPU

AI

CPU: up to 15 TOPS
NPU: 13 TOPS
iGPU: up to 8 TOPS
dGPU: up to 1824 TOPS
Total: up to 1860 TOPS

Total Memory¹

Up to 128GB DDR5 5600MT/s ECC
Up to 192GB DDR5 5600MT/s non-ECC

Memory DIMM Capacity

16GB / 32GB ECC
8GB / 16GB / 32GB / 48GB non-ECC
4 SoDIMM slots

Total Storage

Up to 12TB M.2 PCIe Gen5 NVMe
Performance SSD
Up to 3 x 4TB drives

RAID

0/1/5

Camera

5MP RGB Camera with ThinkPad
Webcam Privacy Shutter

5MP RGB + IR Camera with ThinkPad
Webcam Privacy Shutter and Human
Presence Detection

Battery

99.9Whr, Customer Replaceable

Power Supply

180W PD 3.1 Type-C

Design

Dimensions (Width x Depth x Front / Rear, Max)

362 x 252 x 15.8 / 20.9, 29.8mm
14.25 x 9.92 x 0.62 / 0.82, 1.17in

Weight

Starting at 2.54kg / 5.6lbs

Keyboard

ThinkPad Keyboard with Numeric
Keypad, Backlit, Spill Resistant

Display

16" 16:10 Display

3.2K (3200 x 2000)

- Tandem OLED Touch, 600nit, 40-120Hz VRR, 100% DCI-P3, Anti-Glare/Anti-Reflective/Anti-Smudge, HDR600, Dolby Vision[®], X-Rite FCC, TÜV Eyesafe[®] Low Blue Light, with Pen Support

WQUXGA (UHD+) (3840x2400)

- IPS, 800nit, 100% DCI-P3, Anti-Glare, HDR 400, Dolby Vision, X-Rite FCC, TÜV Eyesafe Low Blue Light

WUXGA (FHD+) (1920 x 1200)

- IPS, Low Power, 500nit, 100% sRGB, Anti-Glare, X-Rite FCC, TÜV Eyesafe Low Blue Light

Connectivity

Ports

(2) USB-A (10Gbps)^{*}
(2) USB-C[®] (Thunderbolt™ 5)
(1) USB-C (Thunderbolt 4)
(1) HDMI[®] 2.1
(1) Audio Jack
(1) Smart Card Reader²
(1) SD Express 8.0 Card Reader
(1) 2.5Gbps RJ-45

Wireless Connectivity

Intel Wi-Fi[®] 7 BE200 (2x2) +
Bluetooth[®] 5.4³

Rolling Wireless RW350R-GL 5G
sub-6GHz CAT19/CAT18 with eSIM²

Near Field Communication (NFC)²

Media Card Reader

SD Express 8.0 Card Reader

¹ Memory spec transfer rate listed; system support transfer rate may vary by configuration

² Optional

³ Bluetooth may be limited by OS

[^] For a full list of configuration details, specifications, and any limitations please visit:

<https://psref.lenovo.com>

^{*} USB port transfer speeds are approximate and depend on many factors, such as processing capability of host/peripheral devices, file attributes, system configuration and operating environments; actual speeds will vary and may be less than expected.

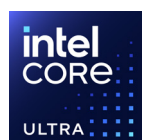

intel
vPRO

That's the power of Intel Inside[®]

Smarter
technology
for all

Lenovo

Lenovo Options & Accessories



ThinkVision P34WD-40 Display



ThinkPad Thunderbolt 5 Smartdock 7500



Meta Quest 3 Mixed Reality VR Headset



Scan for system overview, supported components, and technical specifications.

For a full list of accessories and options, please visit: accsmartfind.lenovo.com

For more details on ThinkStation and ThinkPad, please visit: lenovo.com/workstations

Visit us on social media: [#lenovoworkstations](https://twitter.com/lenovoworkstations)



August 2025 ©Lenovo. All rights reserved. Lenovo is not responsible for photographic or typographic errors. Lenovo makes no representation or warranty regarding third-party products or services. LENOVO, ThinkStation, and ThinkPad are trademarks of Lenovo.

Lenovo ThinkPad P16 Gen 3 General Specifications[^]

Software

Operating System

Windows 11 Pro
Windows 11 Home
Ubuntu® Linux^{®1}
Fedora® Linux^{®1}
Red Hat® Enterprise Linux^{®2}

Windows Preloads

Lenovo Commercial Vantage
Lenovo View
Lenovo AI Now

Additional Features

Discrete Graphics Design
Ultra Performance Mode
Self Healing BIOS

ISV Certifications

Including AVID®, Altair®, ANSYS®, AVEVA, Autodesk, Bentley®, Dassault®, Nemetschek®, PTC®, Schlumberger®, and Siemens®.

For a complete list of ISV certifications visit <https://thinkworkstations.com/>

Security

Intel vPro security

ThinkShield

dTPM 2.0
Touch Fingerprint Reader
Human Presence Detection³
Kensington Lock Slot

Sustainability

Materials

50% Recycled Aluminum A Cover
90% Recycled Magnesium Aluminum C Cover
55% Recycled Aluminum D Cover
85% PCC Plastic Key Caps (non-Black Keyboard)
90% PCC Plastic Speaker Enclosure
97% PCC Plastic Battery Pack Enclosure
90% PCC Plastic 180W Slim AC Adapter
Low Temperature Solder⁴
Plastic free packaging with 90% recycled and/or FSC certified content (standard/bulk)⁵

Certifications

EPEAT^{®6,7} Gold
ENERGY STAR^{®7}
RoHS Compliant
TCO 10.0

Recommended Services

Lenovo offers a comprehensive portfolio of services to support and protect your ThinkPad investment—so you can focus on your business, not your IT.

Premier Support

Bypass phone menus and scripted troubleshooting to access advanced-level technicians with the expertise needed to quickly diagnose and solve problems.

Warranty Extensions

(1 to 5 years total duration)

This fixed-term, fixed-cost service helps you accurately budget for PC expenses, protect your valuable investment, and potentially lower the cost of ownership over time.

Warranty Upgrades—

Onsite and Next Business Day

Maximizes PC uptime and productivity by providing convenient, fast repair service the next business day.

1 Available as preload with select OS versions

2 Certified with select OS versions

3 Optional

4 SSD, fingerprint reader module, FHD+ panel

5 Product packaging shall contain, on average, a minimum total percentage of 90% by weight of any combination of the following materials: Recycled content, biobased plastic, non-wood biobased fiber material, and/or sustainably forested material.

6 EPEAT registered where applicable. EPEAT registration varies by country. See www.epeat.net for registration status by country

7 Certification available on select models

[^] For a full list of configuration details, specifications, and any limitations please visit: <https://psref.lenovo.com>



intel
vPRO

NVIDIA®, and NVIDIA RTX PRO are trademarks and/or registered trademarks of NVIDIA Corporation in the U.S. and other countries. Intel vPro, Core, and Thunderbolt are trademarks of Intel Corporation or its subsidiaries. Linux is the registered trademark of Linus Torvalds in the U.S. and other countries. Ubuntu is a registered trademark of Canonical Ltd. Microsoft and Windows are registered trademarks of Microsoft Corporation. USB-C is a registered trademarks of USB Implementers Forum. Other company, product, and service names may be trademarks or service marks of others.

That's the power of Intel Inside®

Lenovo